

# Radiant Floor Heating Loop Layout - Main Level

**Floor Section Detail**  
 Typical Under Floor Installation  
 for Suspended Floor Applications  
 with Thin Set Pour

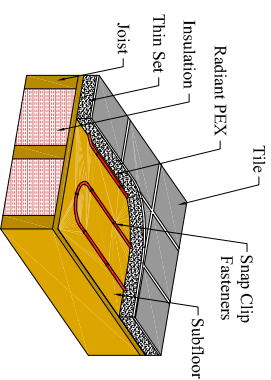

**Design Details**

Floorplan Area 3390 ft<sup>2</sup>  
 Total Tubing Length 4553 ft  
 Tube Size & Type 1/2" PEX  
 Default Tube Spacing 8" cuts unless specified otherwise  
 Install Method Thin Slab (see detail above)

Circuit 1	299 ft	Circuit 13	317 ft - 6" O.C.
Circuit 2	264 ft	Circuit 14	299 ft
Circuit 3	311 ft - 6"/8" O.C.	Circuit 15	285 ft
Circuit 4	311 ft - 6"/8" O.C.	Circuit 16	187 ft
Circuit 5	174 ft	Circuit 17	236 ft
Circuit 6	294 ft - 6"/8" O.C.	Circuit 18	161 ft
Circuit 7	219 ft		
Circuit 8	189 ft		
Circuit 9	247 ft		
Circuit 10	146 ft		
Circuit 11	307 ft		
Circuit 12	307 ft		

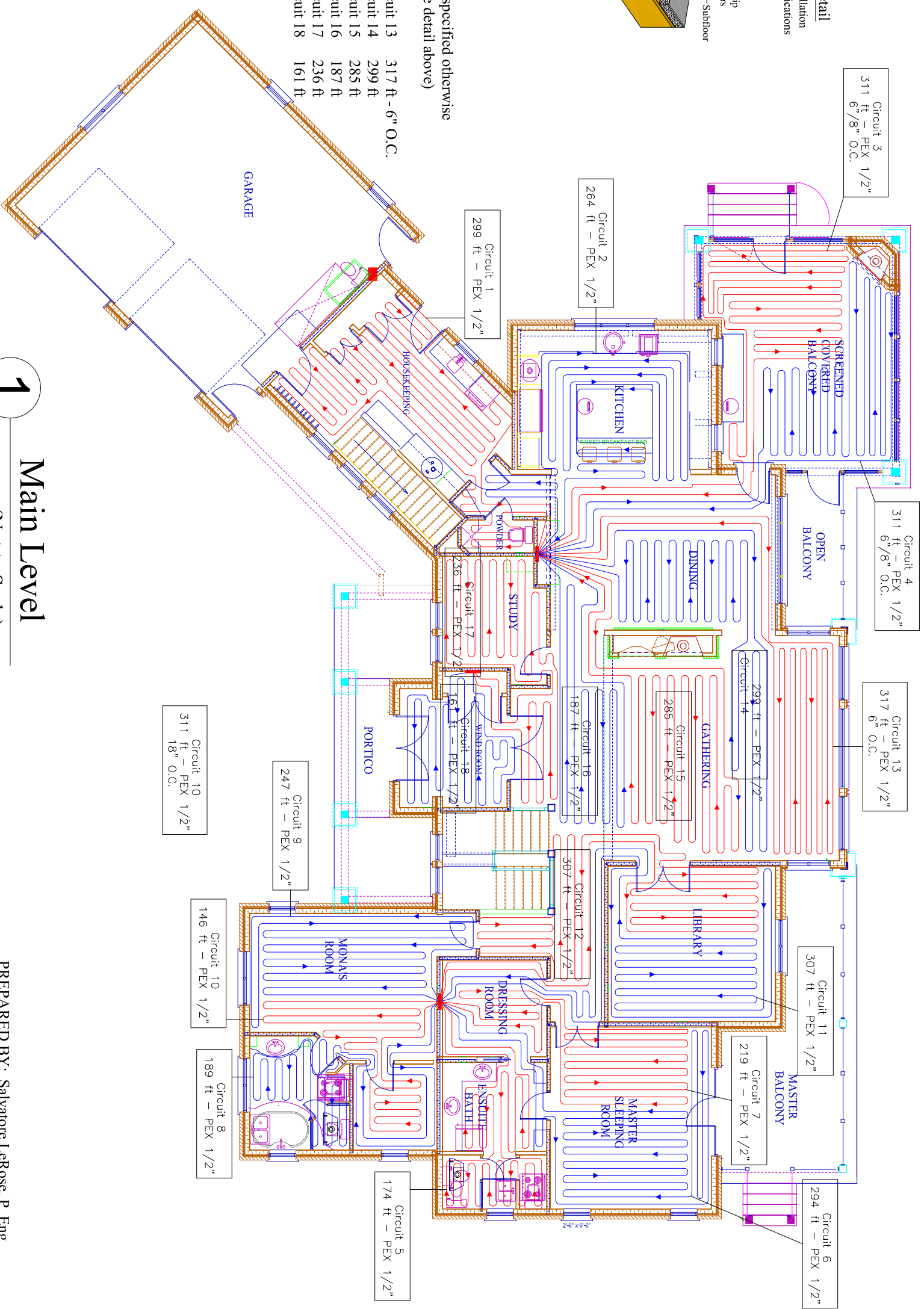

## 1 Main Level (Not to Scale)

PREPARED BY: Salvatore LeRose, P. Eng  
 July 11, 2008

**General Notes**

- 1) Tube bend radius details have been simplified for clarity. Consult manufacturer for bend radius recommendations.
- 2) Layout to be used as a guide for installation purposes. Installer to make adjustments as necessary to suit.

THIS DRAWING IS THE EXCLUSIVE PROPERTY OF HYDRONIC SOLUTIONS INC. AND IS NOT TO BE USED OR DISCLOSED WITHOUT THE PRIOR WRITTEN PERMISSION OF HYDRONIC SOLUTIONS INC.		DWN: S.L.	DATE: 07/11/08	Hillis Country House	TITLE: Radiant Loop Layout Main Level	DWG. NO.: 1012	SCALE: NTS	SHEET 2 OF 2
ENG: S.L.	DATE: 07/11/08	CHKD:	DATE:	FILENAME: L1012-02	HYDRONIC SOLUTIONS INC. 7201 LINE 86, RR#3 WALLENSTEIN, ON, NOB 2S0	REV: A		
APPR:	DATE:	REL:		B/M NO.:				